

HORIZON

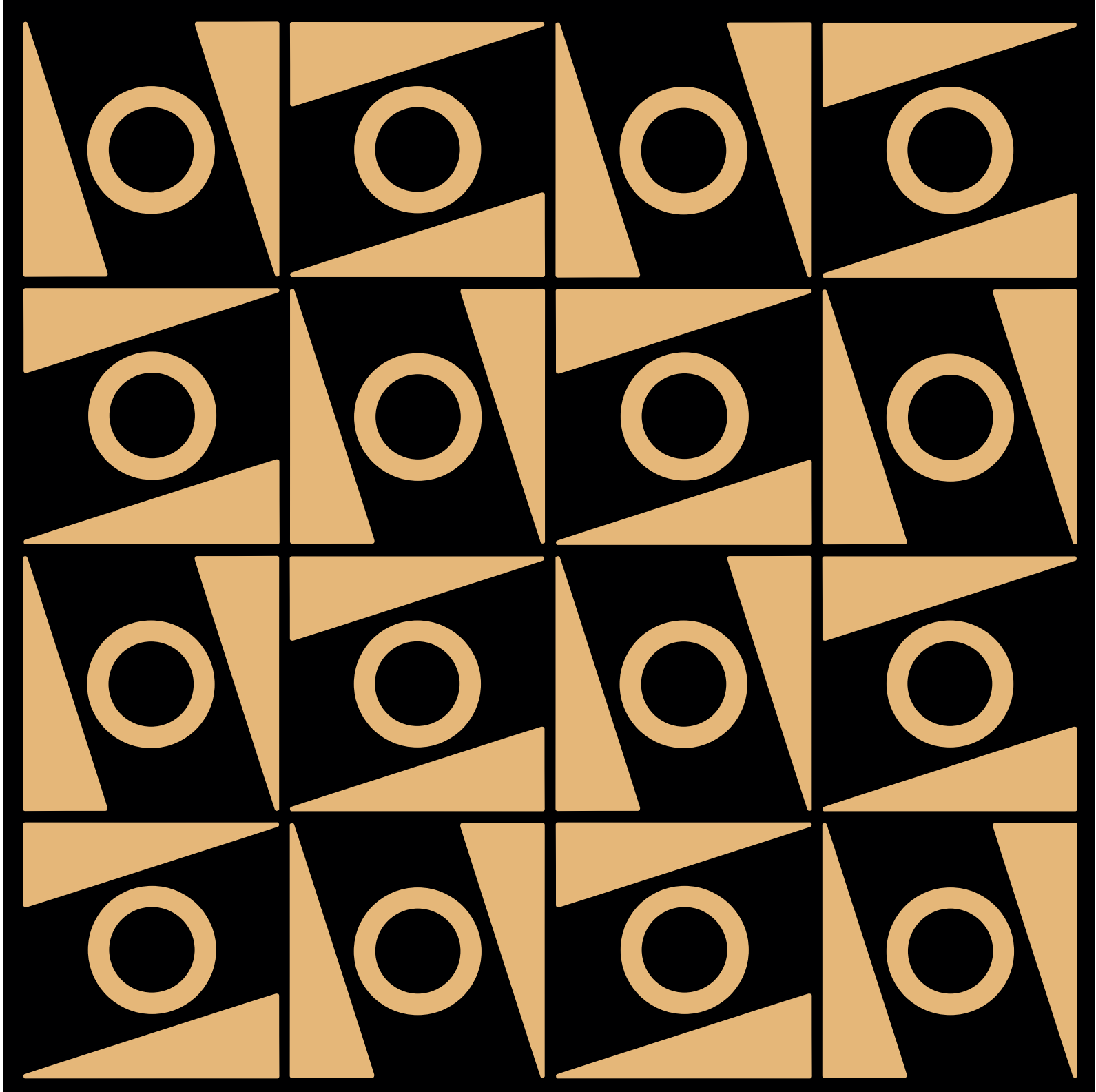

INSTALLATION GUIDE

VER.2021A

WELCOME TO YOUR HILLTOPPER HORIZON ELECTRIC BIKE KIT

Congratulations on the purchase of your Hilltopper Horizon 36V electric bike kit. And welcome to the Hilltopper community of electric bike enthusiasts.

With a small but powerful 350W hub motor and a battery with a range of 25 to 50 miles, the Horizon will get you where you need to go and back. The install should take around an hour depending on your mechanical skills and enthusiasm. You can also take your bike and kit to a local bike shop to have them install your kit. Install fees will vary with different shops.

When you finish your install, double-check that all the bolts are tightened, the connections are secured, the wheel rolls freely, and the battery is charged. Start off slowly at first to get used to the assist.

AND THEN HAVE FUN!

Assumption of Risk. Release of Liability. Indemnity. and Hold Harmless Agreement

By purchasing these Products, I understand and agree to the following:

- (1) Bicycling and related activities are hazardous and injuries are common and ordinary occurrences during these activities. I agree to assume all risks of death or injury to any part of the user's body while using the Products.
- (2) Clean Republic SODO LLC, formerly doing business as Clean Republic and now doing business as Hilltopper, is not responsible for modifications made by me to my bicycle such as fork filing or any modifications made to the Products.
- (3) Non-steel and/or non-rigid forks (aluminum, suspension, etc.) are weaker than rigid steel forks. Clean Republic SODO LLC, formerly doing business as Clean Republic and now doing business as Hilltopper, recommends installation of the Products on rigid steel forks, unless a non-steel fork model is specifically supplied or certified by Hilltopper, although non-steel and/or non-rigid forks are acceptable for use. I agree to assume all risks if I choose installation on non-steel and/or non-rigid forks despite Hilltopper's recommendation.
- (4) Clean Republic SODO LLC, formerly doing business as Clean Republic and now doing business as Hilltopper, recommends tightening the axle nuts with a force of not less than 28 foot-pounds.
- (5) Installing the Products on my bicycle adds additional forces to the bicycle frame and may change handling characteristics. Well-adjusted, well-functioning brakes are key to safely using the Products and operating any bicycle. I understand and agree that I will have my bicycle's brakes inspected by a bicycle repair shop after installation of the Products.
- (6) To the fullest extent allowed by law, I agree to forever release and hold harmless Clean Republic SODO LLC, formerly doing business as Clean Republic and now doing business as Hilltopper, and its owners, agents, employees, and affiliates from any and all responsibility or legal liability for any injuries, damages or death to any user of any equipment and the Products listed in this form, whether resulting from negligence or any other cause. I further agree that I will defend and indemnify them if any claim or action is pursued for any injuries, damages or death relating to bicycling or any related activities involving the use of this equipment and the Products.
- (7) I accept the Products herein "as is" and with no warranties, express or implied, beyond those stated in this agreement and in the manufacturer's written limited warranty, if any.
- (8) I understand how the Products work and have received instruction and satisfactory answers to any questions regarding the use and function of the Products. If this is new equipment, I acknowledge receipt of the manufacturer's written instructions. If at any time the Products do not seem to be working properly, I will stop using it immediately and contact their support department to return it for inspection and possible repair or adjustment.
- (9) If the Products are to be used by someone other than me, I certify that I am acting as agent of the user and that I will provide this form and all pertinent warnings and information to the user.
- (10) This document is a legally binding contract which supersedes any other agreements by and between the parties, and which constitutes the final and entire agreement regarding the services and the Products. This agreement is intended to provide a comprehensive release of all legal liability which is binding upon and for the benefit of all parties, their heirs, agents, and assigns, but is not intended to assert any claims or defenses that are prohibited by law. If any part of this agreement is held to be invalid or unenforceable, the remainder will be given full force and effect. This agreement will be interpreted, construed, and governed by and under Washington State law. Exclusive venue and jurisdiction over the parties and the subject matter to this agreement will be in the Superior Court of Washington in King County.

LET'S GET STARTED

PARTS AND PIECES -

WHEEL W/ HUB MOTOR,
MOUNTING HARDWARE and MOTOR CABLE
TIRE and TUBE
BATTERY and BATTERY DOCK,
MOUNTING HARDWARE,
CHARGER
KEYS (2)
VARIABLE SPEED THROTTLE WITH CABLE
PEDAL ASSIST SENSOR (PAS)
2-PIECE MAGNET WHEEL and ALUMINUM LOCK RING

RECOMMENDED TOOLS -

ALLEN KEY SET
TYPICALLY 4mm ALLEN FOR THE
WATER BOTTLE SCREWS
3mm FOR THE THROTTLE BODY
5mm FOR THE TORQUE ARM
19mm BOX OR ADJUSTABLE WRENCH FOR THE MOTOR AXLE
10mm OR ADJUSTABLE WRENCH FOR THE TORQUE ARM
8mm OR (PREFERABLY) PHILLIPS HEAD(+) FOR THE TORQUE ARM
SCISSORS FOR UNBOXING AND ZIP TIES

INSTALLING THE BATTERY:

The BATTERY is designed to be mounted to your bike using the water bottle mounts on your bike's frame

NOTE: On the frame is the recommended and generally considered ideal placement.
If your bike does not have a place to mount on the frame then a front or rear bike rack can work.

CAUTION: The BATTERY DOCK must be firmly attached. Make sure to tighten the dock bolts periodically.
Any damage to the battery due to insufficient mounting will not be covered under warranty.

STEP 1: Install the BATTERY DOCK on the frame or carrier and use the **provided hardware** to install.

NOTE: Make sure the base of the BATTERY DOCK with the cables points down towards the bottom bracket / pedals.

STEP 2: Insert the BATTERY on to the BATTERY DOCK once it is installed and secured.

CAUTION: You must use the key to lock the battery in place to secure it.

STEP 3: Confirm that the BATTERY is locked and secure before riding.

STEP 4: To remove the BATTERY from the BATTERY DOCK.

A: Insert Key and turn counter-clockwise.
B: Once unlocked simply pull the BATTERY out of the BATTERY DOCK.



CAUTION: Avoid losing your KEYS. They are hard for us to replace.

TURNING THE BATTERY ON / OFF:

Press the red POWER SWITCH on the side of the BATTERY to turn the BATTERY on or off.

You can find the switch under the rubber cover on the side

CAUTION: Make sure to turn the BATTERY off when not in use to avoid accidental throttle engagement and battery drain.

CHARGING THE BATTERY:

NOTE: Charge plug is found under the rubber cover with the power switch

- A. Plug your charger into the wall socket and wait for the light to turn GREEN.
- B. Plug the charger into the battery. The charger light will turn RED and stay RED while charging.
- C. When the charger light turns GREEN your battery is fully charged.

NOTE: Charger will take 6 hours to recharge depleted battery



INSTALLING THE VARIABLE SPEED THROTTLE

We recommend putting the VARIABLE SPEED THROTTLE on the LEFT. Placing them between the handlebar grip and the brake/shifter levers.

NOTE: You may set up your placement differently depending on your preference and bike set up.

STEP 1: Remove handlebar grips.

NOTE: Some grips have locking bolts on the end of the handlebar. If resistance is too great, you can heat the grip with a hair-dryer. Grips may be cut off of the bar, but will need to be replaced.

NOTE: If you wish to install your VARIABLE SPEED THROTTLE on the inside (closer to the stem) of the brake/shifter lever you will need to slide the brake/shifter level off the handlebars

Loosen brake/shifter and slide off of handlebar.
Usually there is only one bolt for each located on the backside or underside of the handlebar.
Cables do not need to be disengaged to remove the brake or shifter levers.

STEP 2: Slide VARIABLE SPEED THROTTLE onto the handlebars

STEP 3: Partially tighten the provided bolt on the underside of the clamp with a 3mm hex wrench.

NOTE: Keep it a little loose until grips are replaced for adjustability.

STEP 4: Slide grips back into place remembering to lock them if they have locking bolts.

NOTE: If you have removed the brake / shifter lever make sure to slide those on before the grips.

STEP 5: After everything is in place and where you want it TIGHTEN each part to avoid any movement once the bike is in use



INSTALLING THE HUB MOTOR WHEEL

Please refer to FIG 1 on the following page for installing your new Hilltopper HUB MOTOR WHEEL.

Please orient FIG 1 to your installation position. Installation positions include bike upside down with handlebars and seat resting on the ground, on a bike rack, or standing with the wheels on the ground. FIG 1 image orientation is looking at the front of the bike with the wheels on the ground.

The best way to orient FIG 1 is to always use the DRIVE SIDE. This is the side with the chain.

STEP 1: Loosen your brakes and remove your bike's front wheel.

DISC BRAKES: After removing your wheel, make sure you put a plastic spacer in between the brake pads to keep them from locking shut. REMOVE THE PLASTIC SPACER BEFORE REINSTALLING YOUR WHEEL.

- A. Remove the disc brake rotor from your wheel.
- B. The HUB MOTOR WHEEL is disc brake compatible.
- C. Align the disc brake rotor with the holes on the MOTOR.
- D. Attach the rotor to the MOTOR using the disc screws provided.

NOTE: Your brake may need some adjusting after installation to avoid rubbing.

STEP 2: Set your HUB MOTOR WHEEL in place with the MOTOR CABLE on the NON DRIVE SIDE.

Ensure that the bike fork is seated securely on the axle with the fork prongs projecting down

Make sure the wheel can turn properly without rubbing or grinding on the fork or brakes.

NOTE: Remove plastic spacer from disc brakes before setting wheel in place if installed earlier.

STEP 3: Slide the **TAB WASHER** over the axle on both sides of the MOTOR.

NOTE: Ensure that the MOTOR CABLE is on the NON DRIVE SIDE of the bike and that the **TAB WASHER** is properly installed.

- A. The "TAB" on the **WASHER** faces inwards towards the MOTOR, and down towards the MOTOR CABLE.
- B. The MOTOR CABLE should be below the axle and **TAB WASHER**, when the bike is standing with the wheels on the ground.

IMPORTANT - INCORRECT TAB WASHER INSTALLATION CAN CAUSE SERIOUS DAMAGE TO THE MOTOR CABLE. THIS IS NOT COVERED UNDER THE HILLTOPPER WARRANTY.

STEP 4: Install the **TORQUE ARM** and rest of the hardware for both sides of the motor

A. Ensure that the tab washer from step 3 is properly installed.

B: Install the drive side hardware:

Step 1: Slide the assembled **TORQUE ARM** onto the axle, with the arm facing forward.

Step 2: Slide the **THICK WASHER** over the axle.

Step 3: Screw the **AXLE NUT** onto the end of the axle and finger tighten.

Step 5: Angle the **ARM** so that it is flush with the right leg of your front fork.

Step 6: Thread the end of the **HOSE-CLAMP BAND** through the narrow slot on the **ARM**, around the right fork leg, and back into itself

Step 7: Finally, when you have the band snug, finger tighter the **LITTLE SCREW** to lock the band in place. The final product should look like this

C: Install the non-drive side hardware

Step 1: Slide the **THICK WASHER** over the axle.

Step 3: Screw the **AXLE NUT** onto the end of the axle and finger tighten.

STEP 6: With the bike right side up, push down from the handle bars to ensure the wheel is fully seated in place. Then use a wrench to fully tighten the **AXLE NUTS**. (Recommended 38Nm or 28ft-lb).

STEP 7: Reset brakes and make sure the HUB MOTOR WHEEL spins freely.

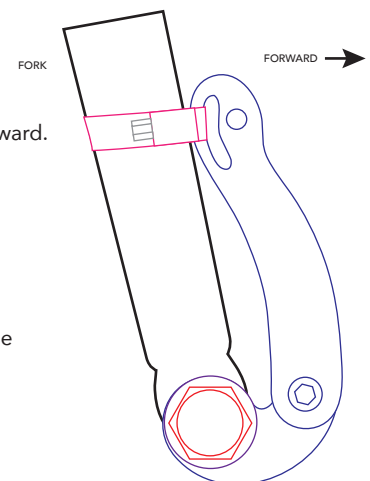
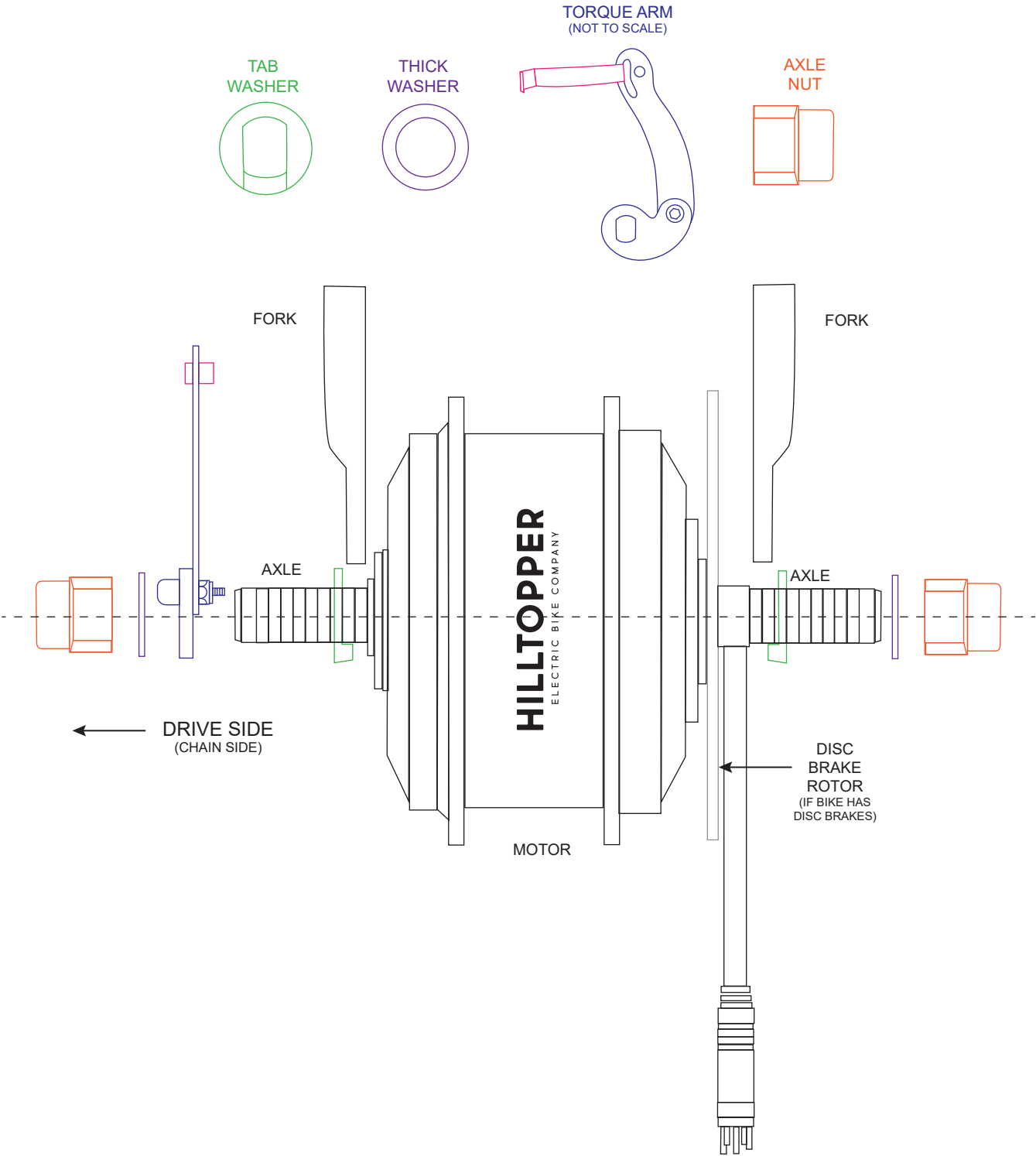

FIG. 1

IMAGE ORIENTATION
LOOKING AT THE FRONT OF THE BIKE WITH
THE WHEELS ON THE GROUND



CONNECTING THE CABLES:

The Horizon 36V BATTERY has 3 cable connections. These will be used to connect the VARIABLE SPEED THROTTLE, PEDAL ASSIST SENSOR and HUB MOTOR, to the battery.

IMPORTANT: Be mindful of the arrows on each plug. Align arrows before inserting plugs together. Poor installation may result in damaged pins and bad connectivity.

NOTE: This type of damage is not covered under warranty.

STEP 1: Connect the BATTERY to the THROTTLE cable using the **BATTERY/ THROTTLE CONNECTOR** with the yellow male 3-pin plug

STEP 2: Connect the BATTERY cable to the MOTOR cable using the **BATTERY / MOTOR CONNECTOR**.

STEP 3: (OPTIONAL - Refer to installation instructions below) Connect the BATTERY to the PAS cable using the **BATTERY/PAS CONNECTOR** with the yellow female 3 pin plug

STEP 4: Secure all your cables with zip ties.

NOTE: Make sure that the cables do not interfere with the steering or hinder the performance of the bike. Damage due to the cables not being properly secured is not covered under warranty.

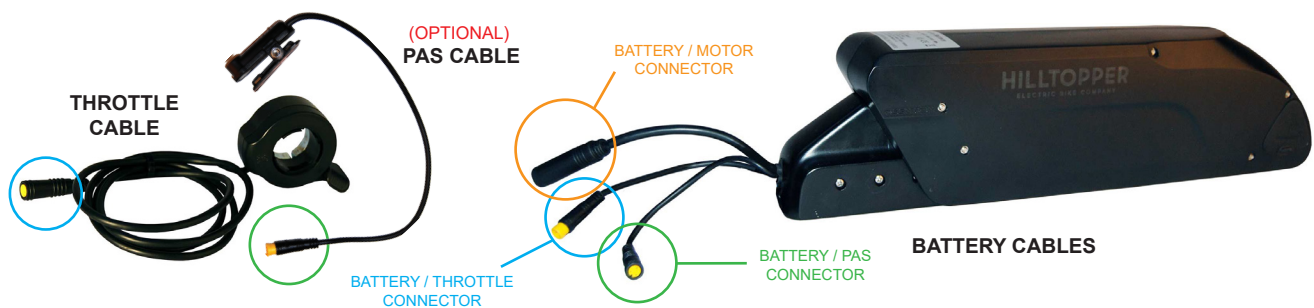
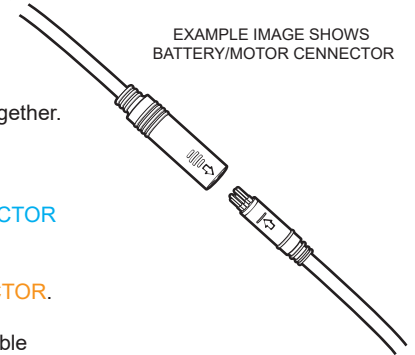

YOU HAVE FINISHED INSTALLING YOUR KIT AND ARE NOW READY TO HIT THE OPEN ROAD. ENJOY!

OPTIONAL INSTALLING THE PEDAL ASSIST SENSOR (PAS) and MAGNET WHEEL:

The PAS and MAGNET WHEEL are optional. If you're interested in adding the optional PAS to your bike, spend a few more minutes to determine if the magnet wheel will fit on your bike.

STEP 1: The MAGNET WHEEL is made up of two pieces. They will both have a "working surface" and ridge side.

- Place each on either side of the spindle behind the DRIVE SIDE crank with working surface facing inward towards the seatpost.
- Push together and use the aluminum ring to hold together. The aluminum ring should stretch and snap into place over/around the two halves of the MAGNET WHEEL to ensure they will not separate.

STEP 2: On the DRIVE SIDE (chain) of your bike place the PAS at the bottom of the SEAT TUBE (right above the cranks and pedals).

- Make sure the red LED is pointed up and the "target" logo is pointed down.
- Align the target with the MAGNET WHEEL magnets.
- Use the provided zip-ties to attach the PAS securely to the seat tube.

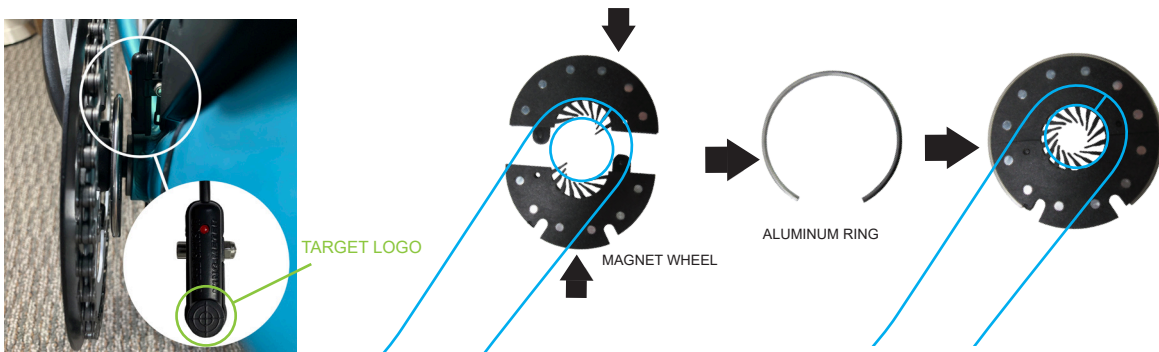



HILLTOPPER

ELECTRIC BIKE COMPANY

sales@hilltopperbikes.com

support@hilltopperbikes.com

920 SOUTH HOLGATE STREET STE. 106

SEATTLE WASHINGTON 98134