

# SPRINTER

INSTALLATION GUIDE

## **WELCOME TO YOUR HILLTOPPER SPRINTER ELECTRIC BIKE KIT**

Congratulations on the purchase of your Hilltopper Sprinter 36V electric bike kit. And welcome to the Hilltopper community of electric bike enthusiasts.

The Sprinter is our simple to use and easy to install kit that utilizes a water bottle battery and front hub motor. The install should take around an hour depending on your mechanical skills and enthusiasm. You can also take your bike and kit to a local bike shop to have them install your kit. Install fees will vary with different shops.

When you finish your install, double check that all the bolts are tightend, the connections are secured, the wheel rolls freely, andthe battery is charged. Start off slowly at first to get used to the assist.

**AND THEN HAVE FUN!**



# LET'S GET STARTED

## PARTS AND PIECES -

WHEEL W/ HUB MOTOR, TIRE, TUBE, MOUNTING HARDWARE

BATTERY, KEYS, BATTERY DOCK, MOUNTING HARWARE

VARIABLE SPEED THROTTLE

CHARGER

## INSTALLING THE BATTERY:

The BATTERY is designed to be mounted to your bike using the water bottle mounts on your bike's frame

NOTE: On the frame is the recommended and generally considered ideal placement.

If your bike does not have a place to mount on the frame then a front or rear bike rack can work.

**CAUTION:** The BATTERY DOCK must be firmly attached. Make sure to tighten cage bolts periodically.  
Any damage to the battery due to insufficient mounting will not be covered under warranty.

**STEP 1:** Install the BATTERY DOCK on the frame or carrier and use the **provided hardware** to install.

NOTE: Make sure the base of the cage with the cables points down towards the bottom bracket / pedals.

**STEP 2:** Insert the BATTERY on to the BATTERY DOCK once it is installed and secured.

**CAUTION:** You must use the key to lock the battery in place to secure it.

**STEP 3:** Confirm that the BATTERY is locked and secure before riding.

**STEP 4:** To remove the BATTERY from the BATTERY DOCK.

A: Insert Key and turn counter-clockwise.

B: Once unlocked simply pull the BATTERY out of the BATTERY DOCK.



BATTERY



## TURNING THE BATTERY ON / OFF:

Press the red POWER SWITCH on the top of the BATTERY to turn the BATTERY on or off. The button will be depressed slightly when on.

**CAUTION:** Make sure to turn the BATTERY off when not in use  
to avoid accidental throttle engagement and battery drain.

## CHARGING THE BATTERY:

A. Plug your charger into the wall socket and wait for the light to turn GREEN.

B. Plug the charger into the battery. The charger light will turn RED and stay RED while charging.

C. When the charger light turns GREEN your battery is fully charged.



## INSTALLING THE HUB MOTOR WHEEL

Please refer to FIG 1 on the following page for installing your new Hilltopper HUB MOTOR WHEEL.

Please orient FIG 1 to your installation position. Installation positions include bike upside down with handlebars and seat resting on the ground, on a bike rack, or standing with the wheels on the ground. FIG 1 image orientation is looking at the front of the bike with the wheels on the ground.

**The best way to orient FIG 1 is to always use the DRIVE SIDE. This is the side with the chain.**

**STEP 1:** Loosen your brakes and remove your bike's front wheel.

DISC BRAKES: After removing your wheel, make sure you put a plastic spacer in between the brake pads to keep them from locking shut.

- A. Remove the disc brake rotor from your wheel.
- B. The HUB MOTOR WHEEL is disc brake compatible.
- C. Align the disc brake rotor with the holes on the MOTOR.
- D. Attach the rotor to the MOTOR using the disc screws provided.

NOTE: Your brake may need some adjusting after installation to avoid rubbing.

**STEP 2:** Slide the **THIN WASHER** over the axle on both side of the MOTOR.

**STEP 3:** Slide the **TAB WASHER** over the axle on both sides of the MOTOR.

NOTE: Ensure that the MOTOR CABLE is on the DRIVE SIDE of the bike and that the **TAB WASHER** is properly installed.

- A. The **"TAB"** on the **WASHER** faces out from the MOTOR, and down towards the MOTOR CABLE.
- B. The MOTOR CABLE should be below the axle and **TAB WASHER**, when the bike is standing with the wheels on the ground.

**IMPORTANT - INCORRECT TAB WASHER INSTALLATION CAN CAUSE SERIOUS DAMAGE TO THE MOTOR CABLE. THIS IS NOT COVERED UNDER THE HILLTOPPER WARRANTY.**

**STEP 4:** Set your HUB MOTOR WHEEL in place with the MOTOR CABLE on the DRIVE SIDE.

Ensure that the bike fork is seated securely on the axle with the fork prongs projecting down on either side of the **"TAB"** of the **TAB WASHER**.

Make sure the wheel can turn properly without rubbing or grinding on the fork or brakes.

NOTE: Remove plastic spacer from disc brakes before setting wheel in place if installed earlier.

**STEP 5:** Install the rest of the hardware for both sides of the motor

- A. Slide the **THICK WASHER** over the axle.
- B: Screw the **AXLE NUT** onto the end of the axle.

**STEP 6:** Finger tighten each **AXLE NUT**.

**STEP 7:** With the bike right side up, push down from the handle bars to ensure the wheel is fully seated in place. Then use a wrench to fully tighten the nuts. ( Recommended 38Nm or 28ft-lb).

**STEP 8:** Slide on each AXLE PROTECTOR CAP.

NOTE: One AXLE PROTECTOR CAP will be attached to the the MOTOR CABLE.

**STEP 9:** Reset brakes and make sure the HUB MOTOR WHEEL spins freely.

**FIG. 1**

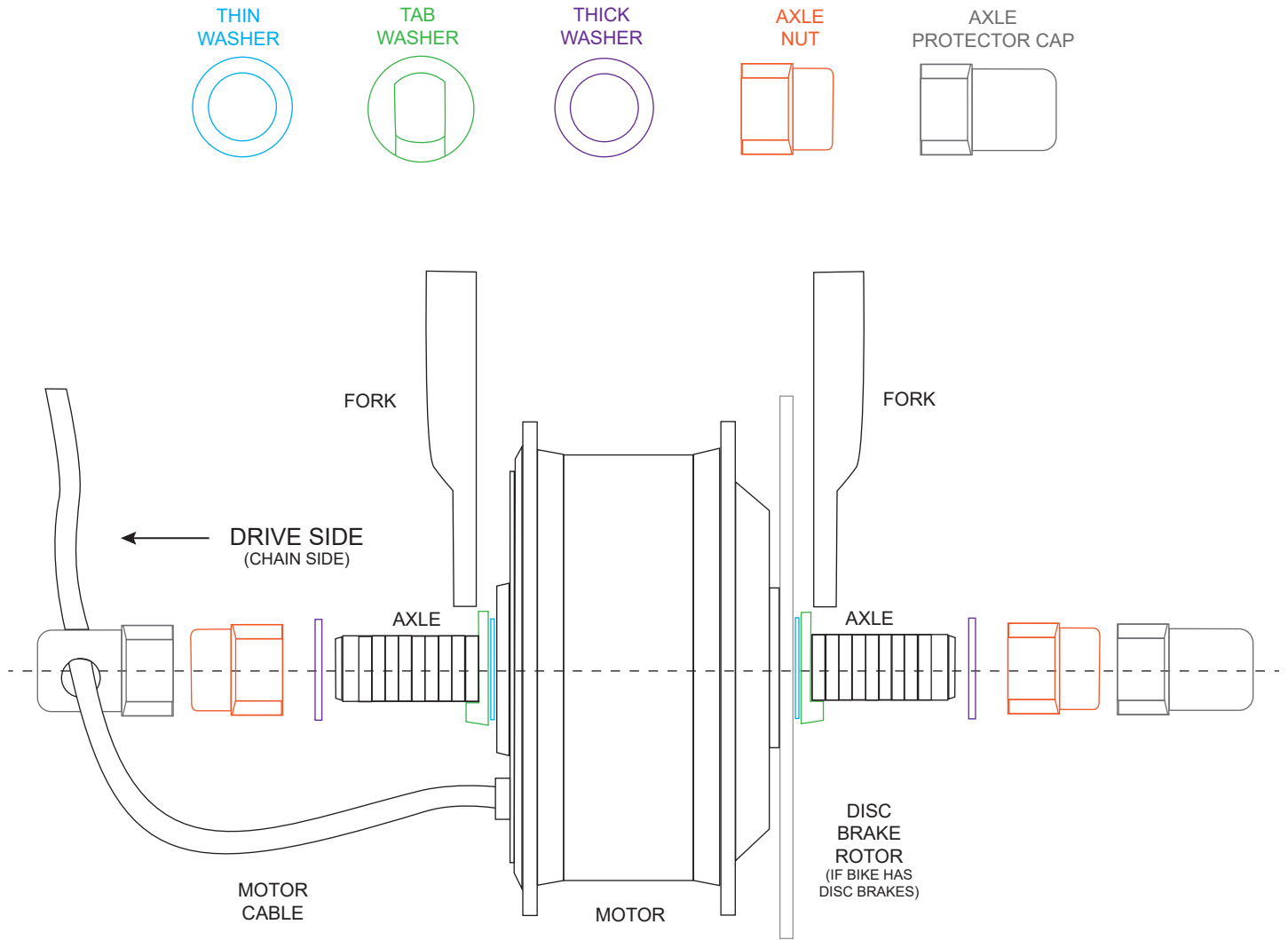
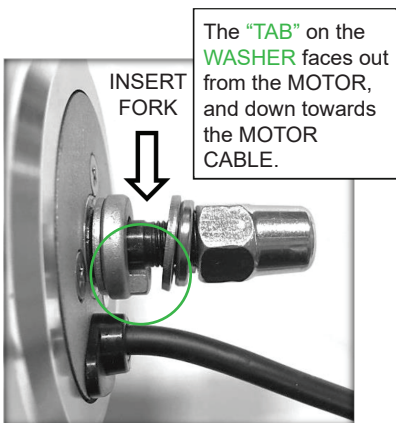
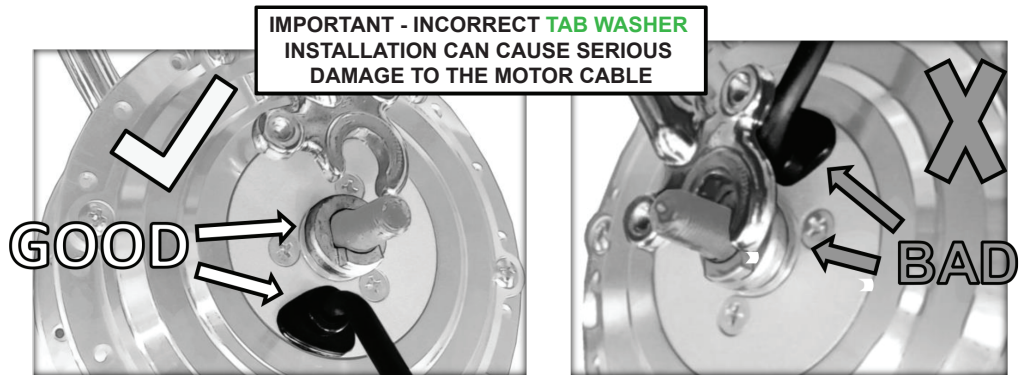

IMAGE ORIENTATION  
LOOKING AT THE FRONT OF THE BIKE WITH  
THE WHEELS ON THE GROUND



THIS IMAGE IS TO ILLUSTRATE  
TAB PLACEMENT ONLY AND  
DOES NOT SHOW THE TORQUE ARM



**CORRECT** - Cable opposite dropout and near TAB

**INCORRECT** - Cable crushed under fork

## INSTALLING THE VARIABLE SPEED THROTTLE

We recommend putting the VARIABLE SPEED THROTTLE on the LEFT. Placing them between the handlebar grip and the brake/shifter levers.

NOTE: You may set up your placement differently depending on your preference and bike set up.

**STEP 1:** Remove handlebar grips.

NOTE: Some grips have locking bolts on the end of the handlebar. If resistance is too great, you can heat the grip with a hair-dryer. Grips may be cut off of the bar, but will need to be replaced.

NOTE: If you wish to install your VARIABLE SPEED THROTTLE on the inside (closer to the stem) of the brake/shifter lever you will need to slide the brake/shifter level off the handlebars

Loosen brake/shifter and slide off of handlebar.

Usually there is only one bolt for each located on the backside or underside of the handlebar.

Cables do not need to be disengaged to remove the brake or shifter levers.

**STEP 2:** Slide VARIABLE SPEED THROTTLE onto the handlebars

**STEP 3:** Partially tighten the provided bolt on the underside of the clamp with a 3mm hex wrench.

NOTE: Keep it a little loose until grips are replaced for adjustability.

**STEP 4:** Slide grips back into place remembering to lock them if they have locking bolts.

NOTE: If you have removed the brake / shifter lever make sure slide those on before the grips.

**STEP 5:** After everything is in place and where you want it TIGHTEN each part to avoid any movement once the bike is in use



## CONNECTING THE CABLES:

The Sprinter 36V BATTERY has 2 cable connections.

### IMPORTANT:

Be mindful of the arrows on each plug. Align arrows before inserting plugs together. Poor installation may result in damaged pins and bad connectivity.

**STEP 1:** The BATTERY / THROTTLE cable connects the BATTERY to the VARIABLE SPEED THROTTLE

- Connect the BATTERY cable to the VARIABLE SPEED THROTTLE cable using the yellow connector

**STEP 2:** The BATTERY / MOTOR cable (large cable) connects the BATTERY to the MOTOR.

- Connect the BATTERY cable to the MOTOR cable using the BATTERY / MOTOR CONNECTOR .

**STEP 3:** Secure all your cables with zip ties.

NOTE: Make sure that the cables do not interfere with the steering or hinder the performance of the bike.

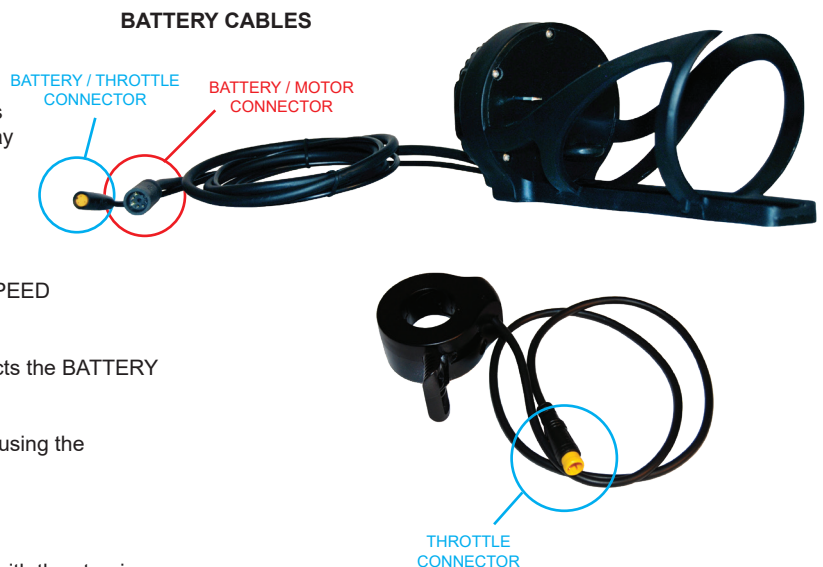

**Assumption of Risk, Release of Liability, Indemnity, and Hold Harmless Agreement**

By purchasing these Products, I understand and agree to the following:

- (1)     Bicycling and related activities are hazardous and injuries are common and ordinary occurrences during these activities. I agree to assume all risks of death or injury to any part of the user's body while using the Products.
- (2)     Clean Republic SODO LLC, formerly doing business as Clean Republic and now doing business as Hilltopper, is not responsible for modifications made by me to my bicycle such as fork filing or any modifications made to the Products.
- (3)     Non-steel and/or non-rigid forks (aluminum, suspension, etc.) are weaker than rigid steel forks. Clean Republic SODO LLC, formerly doing business as Clean Republic and now doing business as Hilltopper, recommends installation of the Products on rigid steel forks, unless a non-steel fork model is specifically supplied or certified by Hilltopper, although non-steel and/or non-rigid forks are acceptable for use. I agree to assume all risks if I choose installation on non-steel and/or non-rigid forks despite Hilltopper's recommendation.
- (4)     Clean Republic SODO LLC, formerly doing business as Clean Republic and now doing business as Hilltopper, recommends tightening the axle nuts with a force of not less than 28 foot-pounds.
- (5)     Installing the Products on my bicycle adds additional forces to the bicycle frame and may change handling characteristics. Well-adjusted, well-functioning brakes are key to safely using the Products and operating any bicycle. I understand and agree that I will have my bicycle's brakes inspected by a bicycle repair shop after installation of the Products.
- (6)     To the fullest extent allowed by law, I agree to forever release and hold harmless Clean Republic SODO LLC, formerly doing business as Clean Republic and now doing business as Hilltopper, and its owners, agents, employees, and affiliates from any and all responsibility or legal liability for any injuries, damages or death to any user of any equipment and the Products listed in this form, whether resulting from negligence or any other cause. I further agree that I will defend and indemnify them if any claim or action is pursued for any injuries, damages or death relating to bicycling or any related activities involving the use of this equipment and the Products.
- (7)     I accept the Products herein "as is" and with no warranties, express or implied, beyond those stated in this agreement and in the manufacturer's written limited warranty, if any.
- (8)     I understand how the Products work and have received instruction and satisfactory answers to any questions regarding the use and function of the Products. If this is new equipment, I acknowledge receipt of the manufacturer's written instructions. If at any time the Products do not seem to be working properly, I will stop using it immediately and contact their support department to return it for inspection and possible repair or adjustment.
- (9)     If the Products are to be used by someone other than me, I certify that I am acting as agent of the user and that I will provide this form and all pertinent warnings and information to the user.
- (10)    This document is a legally binding contract which supersedes any other agreements by and between the parties, and which constitutes the final and entire agreement regarding the services and the Products. This agreement is intended to provide a comprehensive release of all legal liability which is binding upon and for the benefit of all parties, their heirs, agents, and assigns, but is not intended to assert any claims or defenses that are prohibited by law. If any part of this agreement is held to be invalid or unenforceable, the remainder will be given full force and effect. This agreement will be interpreted, construed, and governed by and under Washington State law. Exclusive venue and jurisdiction over the parties and the subject matter to this agreement will be in the Superior Court of Washington in King County.



**HILLTOPPER**

ELECTRIC BIKE COMPANY

[sales@hilltopperbikes.com](mailto:sales@hilltopperbikes.com)

[support@hilltopperbikes.com](mailto:support@hilltopperbikes.com)

920 SOUTH HOLGATE STREET STE. 106

SEATTLE WASHINGTON 98134